



Help, the Earth is Shaking!

What to do in case of an incident?

Earthquakes cannot be predicted. Possible effects and damage can, however, be minimized using simple measures at home and on vacation.

before



during

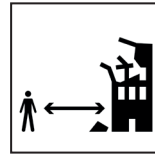

after

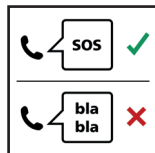
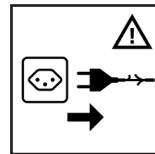

Before a strong earthquake

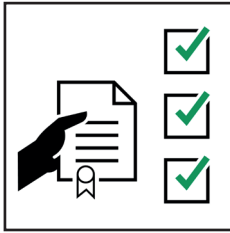

New, redeveloped, and converted buildings

- Earthquake-resistant building design (following SIA building code 260 ff.) offers the best protection against the consequences of an earthquake. The primary goal of this type of design is to prevent the collapse of a building and thereby avoid fatalities and injuries.
- Consider taking out earthquake insurance to reduce your personal (financial) risk.

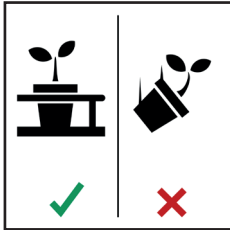

Sources of danger inside buildings

- Make sure that objects that could fall down or topple over due to the shaking, and thereby cause injuries, are secured. This includes, for example, ceiling linings, shelves and their contents, televisions and stereos, and light fittings.

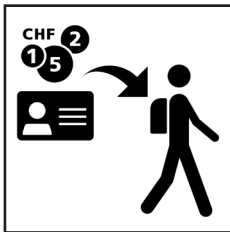

Be prepared (for earthquakes and other emergencies)

- Think about what to do during an earthquake (see "During a strong earthquake").
- Know where the main valves and switches for gas, water, and electricity are and how to turn them off.
- Keep a supply of emergency provisions (see flyer „provisions“ from the Federal Office for National Economic Supply FONES).
- Put together a first aid box.
- Copy important documents such as your passport or driver's license and have them within reach in case of an incident.
- Have a torch, battery-powered radio, and cash (ATMs may no longer function) within reach in case of power cuts.



During a strong earthquake



Inside a building

- Take cover (e.g. under a sturdy table).
- Beware of falling or toppling objects (e.g. shelves, heavy furniture, televisions and stereos, light fittings) and keep away from windows and glass walls, which may shatter.

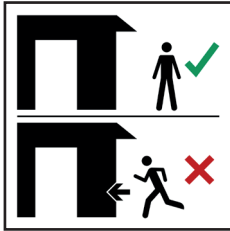

- Only leave the building when the surrounding area is safe (when there are no more falling objects such as roof tiles, etc.).

Outside

- Stay outside, do not seek shelter in a building.
- Keep away from buildings, bridges, electricity pylons, large trees, and other things that could collapse or fall.
- Keep away from the shores of waterbodies.

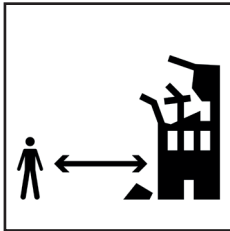

In a vehicle

- Stop the vehicle and do not leave it during the earthquake.
- Do not stop on bridges, in underpasses, or tunnels.
- Keep away from buildings at the side of the road (danger of collapse).

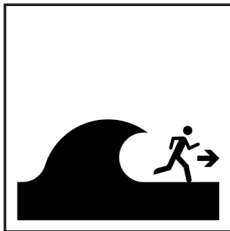

After a strong earthquake



In the damage area

- Expect aftershocks.
- Help others without putting yourself in danger.
- Check building for damage. Leave the building in case of severe damage. The building may be at risk of collapsing and will not withstand further earthquakes.
- Caution when leaving the building. Pieces of masonry, roof beams, tiles, and the like may still fall off.
- Check the building and surrounding area for potential fires. When possible, extinguish small fires and / or alert the fire service.
- Check water and gas pipes and electrical wiring for damage. Turn off supply if damage is suspected.
- Seek information from television, radio, or the internet.
- Follow the instructions of emergency service personnel.
- Only use telephones in an emergency. Phone lines should be kept free for genuine emergencies.
- No individual travel by car. Roads should be kept free for emergency services.
- Power cuts are likely.

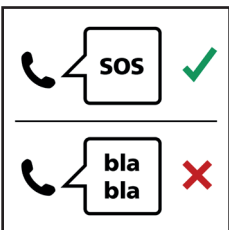
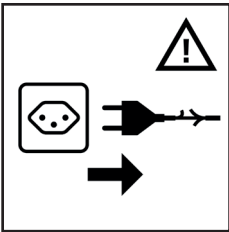

What does the Swiss Seismological Service do in case of an incident?

The SED monitors ground shaking around the clock. Within approximately 90 seconds of an earthquake, details about the time, location, magnitude, and possible effects are displayed on the website www.seismo.ethz.ch. The SED automatically reports any noticeable earthquakes to the authorities and the media. At the same time, this information is transmitted to the SED's 24-hour on-call service via pager, e-mail, and SMS. This service is also available to the authorities and the media for further information about current earthquakes, and prepares background information that is published on the SED website. In case of earthquakes that cause major damage worldwide, the SED additionally informs the Swiss Humanitarian Aid Unit (SHA).

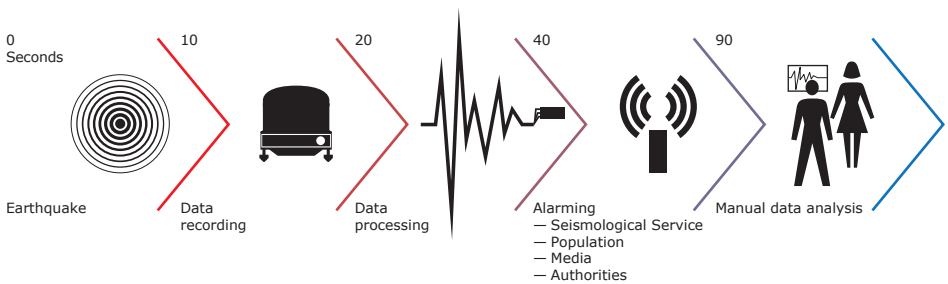

Informed at any time

SED website

Here you will find lots of background information about all aspects of earthquakes besides detailed information about earthquakes in Switzerland and abroad.

www.seismo.ethz.ch

Have you felt an earthquake?

Submit your observations via the online questionnaire on the SED website.

www.seismo.ethz.ch/en/earthquakes/did-you-feel-an-earthquake/

@seismoCH_E

Follow us on Twitter and receive an immediate notification when an earthquake with a magnitude of 2.5 or greater has occurred in Switzerland or neighboring countries.

www.twitter.com/seismoCH_E

Natural hazards portal

The SED earthquake announcements are also published on the federal natural hazards portal.

www.natural-hazards.ch

www.meteoswiss.admin.ch

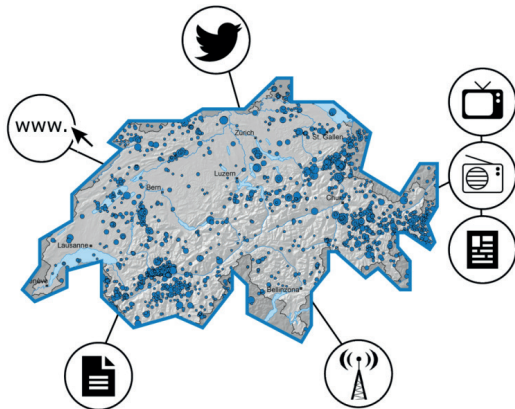

Swiss Seismological Service
ETH Zurich
Sonneggstrasse 5
8092 Zurichh

© 2022, pictograms (p. 1-4) © FOCP